

CHANNELSIDE RE-GRADE  
PHASE 3

**FDOT** This Certifies that  
**Mark C. Crawford**  
Has Completed a Florida Department of Transportation Approved  
Temporary Traffic Control (TTC) Advanced Course.  
Date Expires: 03/31/2020 Certificate # 16356  
Instructor: Catharine Witt FDOT Provider # 37

ATSSA  
Phone: 540-365-1701  
15 Riverside Parkway Ste.100  
Fredericksburg, VA  
www.atssa.com  
donna.clark@atssa.com



SAFER ROADS SAVE LIVES

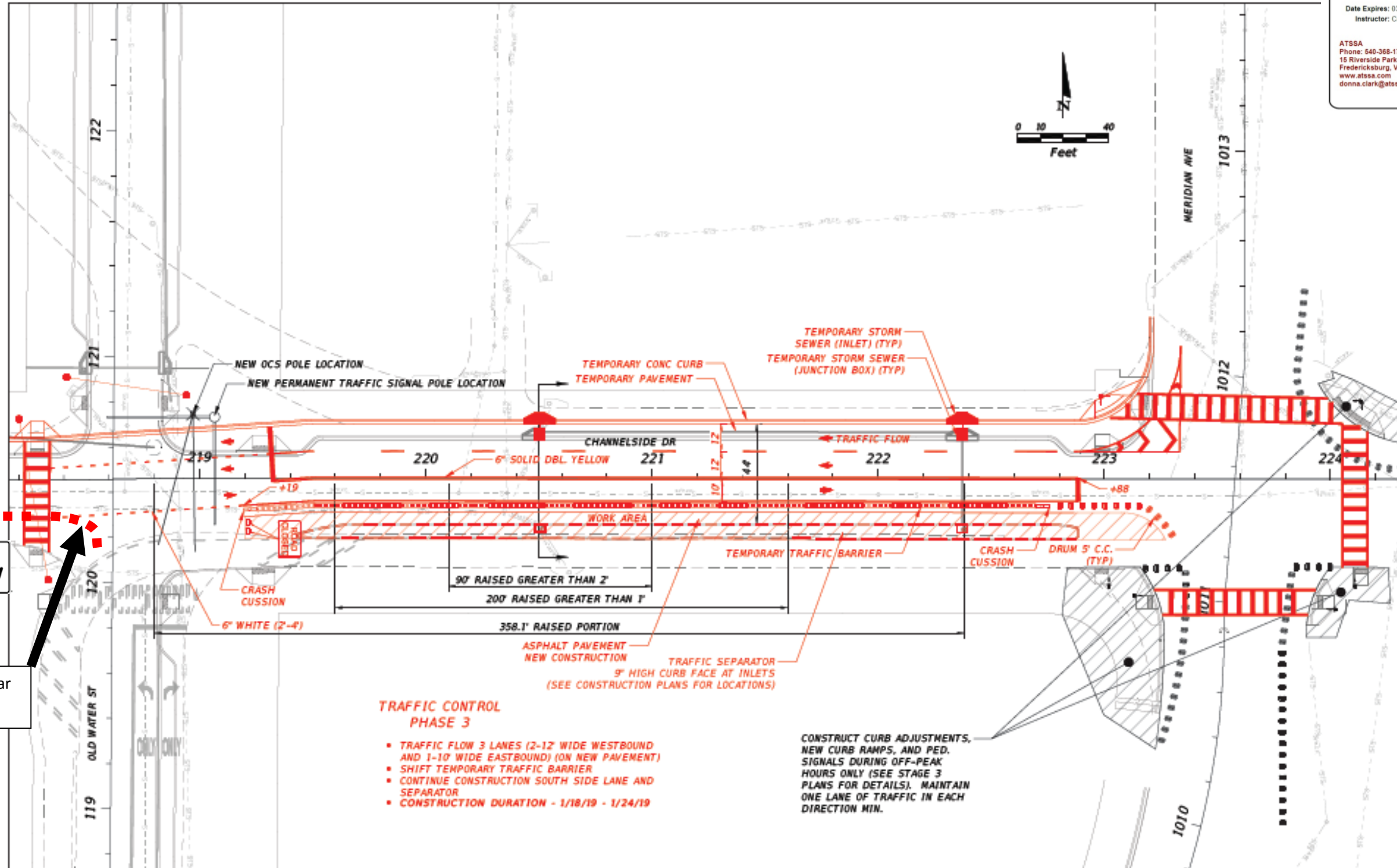

RIGHT LANE  
MUST  
TURN RIGHT

ONLY

Use drums to force vehicular traffic into right turn only.

- TRAFFIC CONTROL PHASE 3**
- TRAFFIC FLOW 3 LANES (2-12' WIDE WESTBOUND AND 1-10' WIDE EASTBOUND) (ON NEW PAVEMENT)
  - SHIFT TEMPORARY TRAFFIC BARRIER
  - CONTINUE CONSTRUCTION SOUTH SIDE LANE AND SEPARATOR
  - CONSTRUCTION DURATION - 1/18/19 - 1/24/19

CONSTRUCT CURB ADJUSTMENTS, NEW CURB RAMPS, AND PED. SIGNALS DURING OFF-PEAK HOURS ONLY (SEE STAGE 3 PLANS FOR DETAILS). MAINTAIN ONE LANE OF TRAFFIC IN EACH DIRECTION MIN.

REVISIONS		DATE	DESCRIPTION	 1775 Harbour Blvd, Suite 200, Tampa, FL 33606 P: 813 220 8800 F: 813 220 0000 www.stantec.com ©2019 Stantec Services, Inc. • 00477010 • FL Lic. #LC3600004	 CITY OF TAMPA ECONOMIC AND URBAN DEVELOPMENT DEPARTMENT	WATERFRONT DISTRICT CONSTRUCTION SEQUENCE CHANNELSIDE DR.	SHEET NO. PH-2
DATE	DESCRIPTION						



CHANNELSIDE RE-GRADE  
PHASE 3

**FDOT** This Certifies that  
**Mark C. Crawford**

Has Completed a Florida Department of Transportation Approved  
Temporary Traffic Control (TTC) Advanced Course.

Date Expires: 03/31/2020 Certificate # 16356  
Instructor: Catherine Witt FDOT Provider # 37

**ATSSA**  
SAFER ROADS SAVE LIVES

ATSSA  
Phone: 540-368-1701  
15 Riverside Parkway Ste. 100  
Fredericksburg, VA  
www.atssa.com  
donna.clark@atssa.com

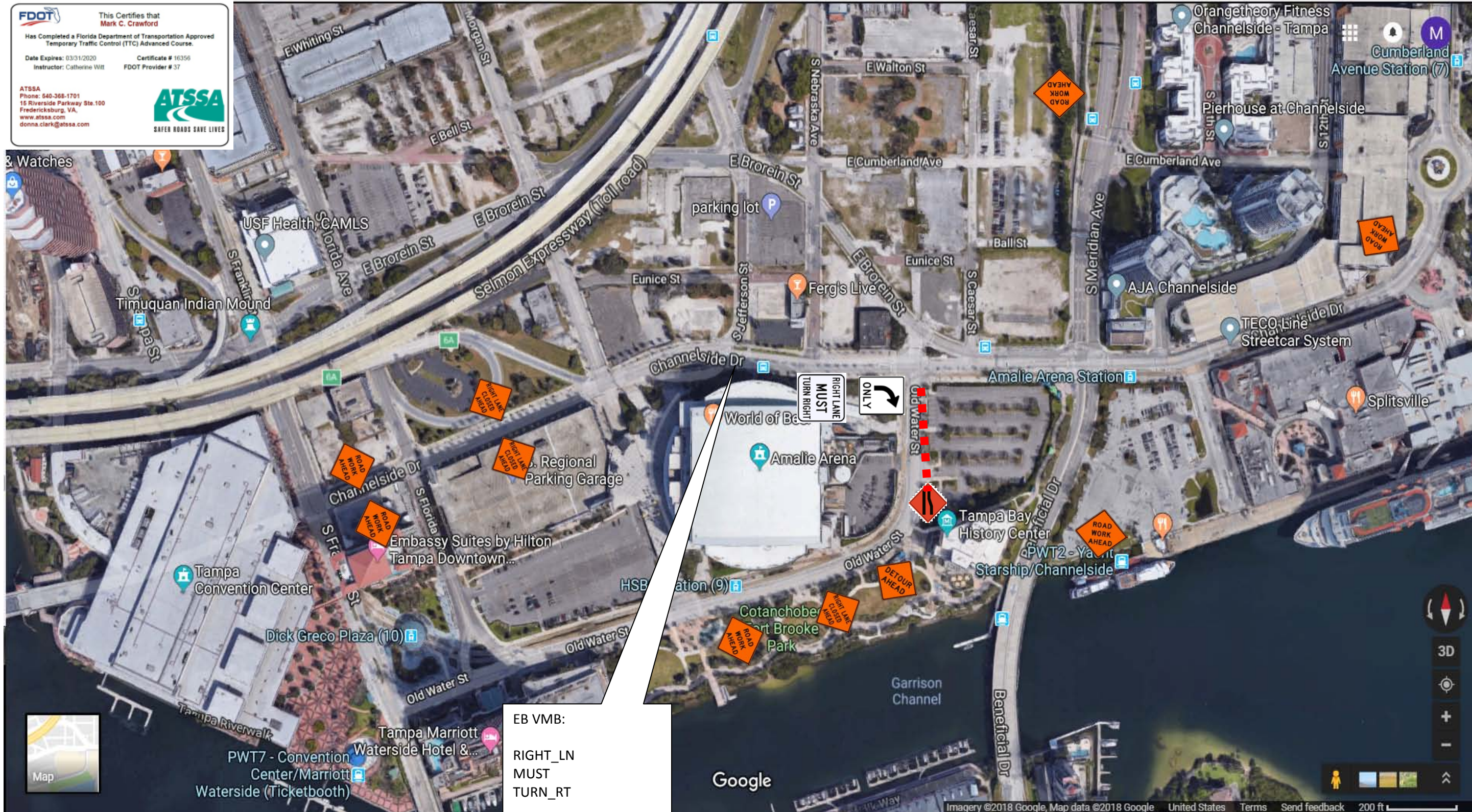

EB VMB:  
RIGHT\_LN  
MUST  
TURN\_RT

THRU  
TRAFFIC  
KEEP\_LFT

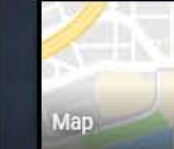



CHANNELSIDE RE-GRADE  
PHASE 3

